

Our Case Number: ABP-313509-22

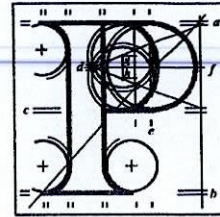

**An
Bord
Pleanála**

Patrick Byrne
Life Pharmacy
4 Merrion Road
Ballsbridge
Dublin 4
D04 R7X2

Date: 18 July 2022

Re: BusConnects Belfield/Blackrock to City Centre Core Bus Corridor Scheme
Co. Dublin

Dear Sir,

An Bord Pleanála has received your submission in relation to the case mentioned above and will take it into consideration in its determination of the matter. Please accept this letter as a receipt for the fee of €50 that you have paid.

Please be advised that copies of all submissions / observations received in relation to the application will be made available for public inspection at the offices of An Bord Pleanála when they have been processed by the Board.

For further information on this case please access our website at www.pleanala.ie and input the 6-digit case number into the search box. This number is shown on the top of this letter (for example: 303000).

Yours faithfully,

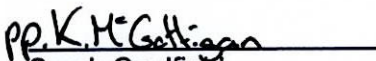

Sarah Caulfield
Executive Officer
Direct Line: 01-8737287

BL50A

Tel
Glao Áitiúil
Facs
Láithreán Gréasáin
Ríomhphost

Tel
LoCall
Fax
Website
Email

(01) 858 8100
1890 275 175
(01) 872 2684
www.pleanala.ie
bord@pleanala.ie

64 Sráid Maoilbhríde
Baile Átha Cliath 1
D01 V902

64 Marlborough Street
Dublin 1
D01 V902

**Strategic Infrastructure
An Bord Pleanála.
64 Marlborough Street
Dublin 1
D01V902**

12/07/2022

Bus Connects – Belfieldblackrockscheme

Dear Sir / Madam

I have grave concerns about the design of the proposed scheme for the Ballsbridge section of the Bus connects scheme in particular how it crosses with the Dodder Greenway. The implementation of a proper integrated cycling and pedestrian scheme is vital for our area and could vastly improve pedestrian and cyclist safety if done properly . Alas the proposal as drafted fails residents , pedestrians , cyclists and business owners.

The proposal outlines a toucan crossing indicated in yellow in the figure below .

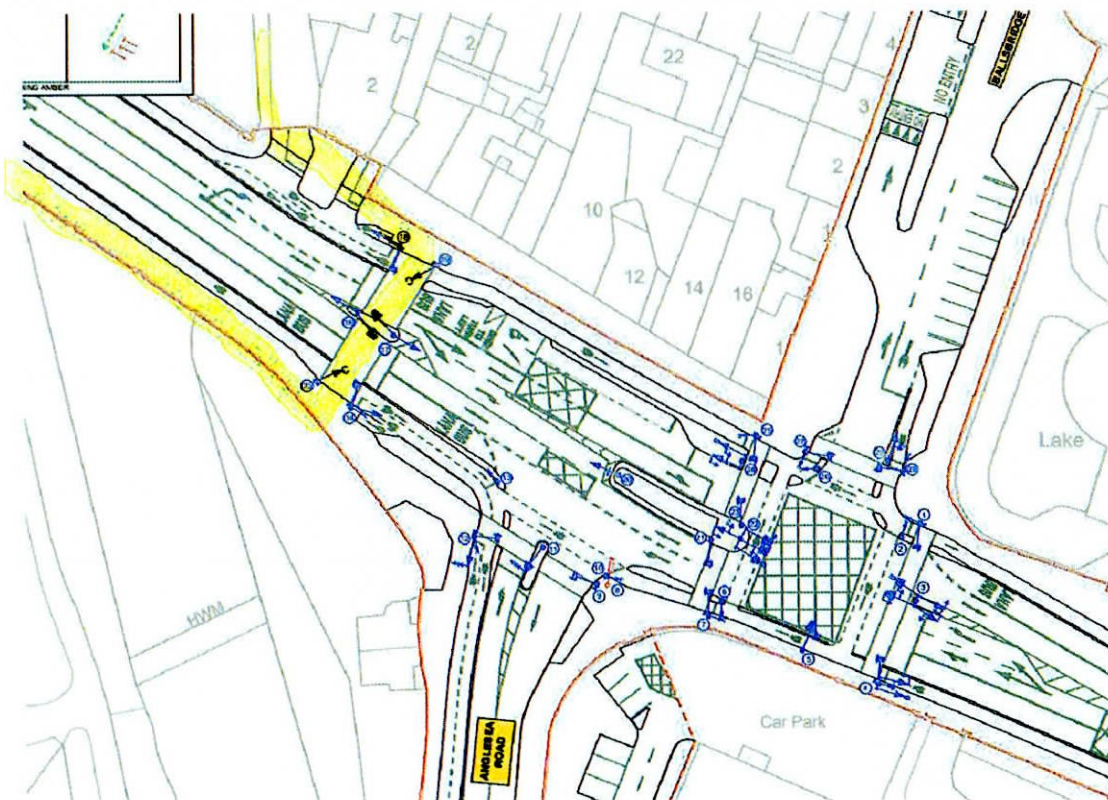

Patrick Byrne MPSI , 4 Merrion Road ,
Ballsbridge, Dublin 4. D04 R7X2
Tel 01 6683287 fax 01-6683050 Mobile 087 2546322

- 1) The majority of pedestrians walking up stream exit Beatty's avenue crossing straight or veering right over the bridge , dangerously crossing the bridge and continue their journey up along the Herbert Park Lane side .

The majority of pedestrians enjoying the Dodder walk downstream come from Herbert park and currently cross the bridge dangerously and illegally to continue to Beatty's Ave.

A solution to this is a pedestrian crossing on the bridge at the top of Beatty's avenue . see below figure 2 . This would greatly improve safety for pedestrians crossing the Dodder Bridge.

As currently planned no pedestrians will turn left at Beatty's Ave to cross at the proposed Toucan crossing outside insomnia , 8 Merrion Road, leaving the footpath located on the right hand side along the Dodder wall crossing the greenway. To have pedestrians crossing left over the greenway is dangerous and an unnecessary complication .

Similarly pedestrians coming downstream from Herbert Park Lane are not going to walk all the way to the end of Anglesea Road to cross on a Toucan and double back beside a two way cycle path .

Figure 2- yellow new pedestrian crossing at beatty's ave – black lines greenway crossing toucan

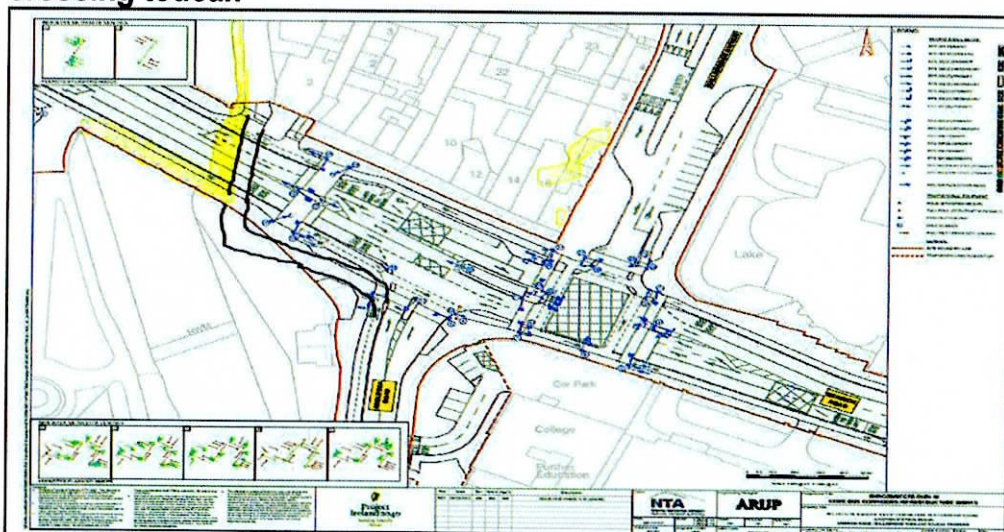

- 2) Similarly the proposed Greenway crossing can be co located as a toucan with the pedestrian crossing at the top of Beatty's ave . Some of the vacant Horse Show pitchers site would be needed to facilitate this . The wall to that site is the original wall and did not form part of the new flood relief works recently undertaken . It does form part of the Flood barrier but could be relocated in order to utilise the Horse Show pitchers site as part of the public realm .
- 3) Under the scheme as drafted the disabled spot outside my Pharmacy would be moved a considerable distance to outside Crowes pub . This would make it extremely difficult for some elderly and disabled patients to access my Pharmacy and is unnecessary . As it is there is a 350mm height differential between granite place and the footpath in front of my building and the design as drafted does not provide a solution for this height differential .
- 4) The above are minor changes to the scheme but would vastly improve the scheme in our area where I have worked daily for 35 years . I know and understanding this area and would hope busconnects would learn from local knowledge .
- 5) Finally a small request ,having discussed the maintenance of planting in Ballsbridge with Herbert Park manager and our tidy towns group we would request a well be provided in the public realm for watering of summer plants . Currently water is transported from two locals wells at considerable effort and a local well source would be very welcome .

Yours faithfully

Patrick J Byrne Bsc(Pharm) MPSI

Patrick Byrne

BSc(Pharm) Dip Psych Therapeutics MPSI



Patrick Byrne MPSI , 4 Merrion Road ,
Ballsbridge, Dublin 4. D04 R7X2
Tel 01 6683287 fax 01-6683050 Mobile 087 2546322